

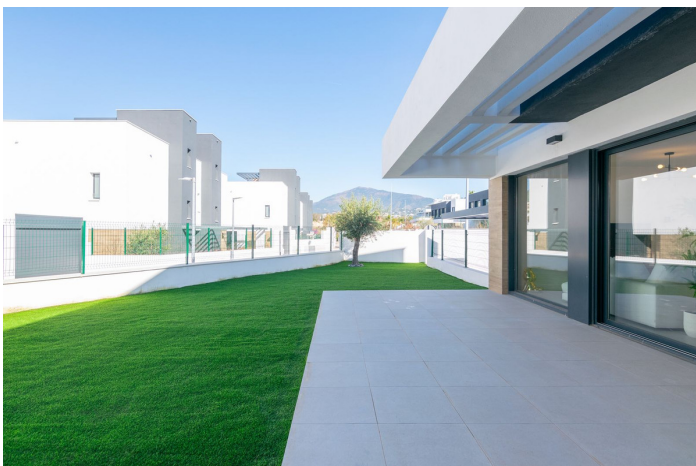

Semi-Detached House for sale in Atalaya, Estepona

950,000 €

Reference: R5327509 Bedrooms: 3 Bathrooms: 3 Plot Size: 111m² Build Size: 180m² Terrace: 32m²





Costa del Sol, Atalaya

Contemporary Corner Semi-Detached Home in Atalaya with Greater Privacy, Private Garden and Flexible Basement Space

Set within a modern residential community in Atalaya, this south-facing corner semi-detached home combines contemporary architecture, generous natural light and a practical layout designed for comfortable everyday living. Its corner position gives it a clear advantage over a typical internal unit, offering greater privacy, a more open overall feel and a larger private garden to enjoy throughout the year.

The property offers 180 m² of built space, a 32 m² terrace and a 111 m² private plot. The main floor is centred around an open-plan living and dining area with large windows and direct access to the outdoor spaces, creating an easy connection between the interior, the covered terrace and the garden. The kitchen, with its central island and clean modern lines, reinforces the home's bright, functional and social character.

Upstairs, the bedroom accommodation is well suited to family life or extended stays, while the lower level adds valuable flexibility. Currently arranged as a multi-purpose leisure area, the basement can easily serve as a games room, gym, cinema room, office, guest area or additional family space depending on the buyer's needs.

With private parking for two vehicles, a low-maintenance garden and access to the communal pool, this is a strong option for buyers looking for a modern home with more privacy than a standard semi-detached unit, within easy reach of golf, schools and the main routes connecting Marbella, Estepona and the wider coast.



Features:

Features

Covered Terrace
 Private Terrace
 Satellite TV
 Storage Room
 Ensuite Bathroom
 Double Glazing
 Fitted Wardrobes
 Utility Room
 Barbeque
 WiFi
 Fiber Optic
 Basement

Views

Mountain
 Garden

Pool

Communal

Garden

Private
 Easy Maintenance

Utilities

Electricity

Orientation

South

Setting

Close To Golf
 Urbanisation
 Close To Schools

Furniture

Fully Furnished

Security

Electric Blinds
 Entry Phone

Category

Holiday Homes
 Investment
 Resale
 Golf
 Luxury
 Contemporary

Climate Control

Air Conditioning
 Central Heating

Condition

New Construction

Kitchen

Fully Fitted

Parking

Garage
 Private
 More Than One
 Open